

### Features & Benefits

- To be mounted on the exhaust port of a solenoid valve to protect internal parts from the environment



### General

Operating pressure	0 to 10 bar (1) (2) (3)
Fluid temperature range	-10°C to +80°C (1) (2) (3)
Ambient temperature range	-10°C to +80°C (1) (2) (3)
Load loss	Minimum

### Specifications

Construction	(1)	(2)
body	porous plastic	porous bronze
connection piece	plastic	brass
Pipe size	Catalog number	
	-	(set of 2)
Ø M5	34600405	-
G 1/8	34600406	97701875
G 1/4	34600407	97701876
G 3/8	34600408	-
G 1/2	34600409	-

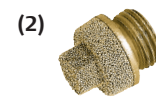
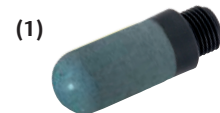

Construction	(3)		
body	stainless steel		
connection piece	nickel plated brass		
Pipe size	M	G (ISO 228/1)	NPT
	Catalog number		
Ø M5	34600484	-	-
1/8"	-	34600418	34600482
1/4"	-	34600419	34600483
3/8"	-	34600478	-
1/2"	-	34600479	34600481



**Dimensions (mm), Weight (kg)**

**Silencer (1) - Exhaust Protector (2) (3) - Performance Exhaust Protector (4)**

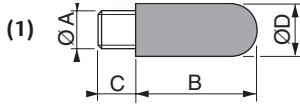

Catalog number	ØA	B	C	ØD	weight
34600405	M5	17.5	4	6.5	0.0005
34600406	G1/8	28.5	5.5	12.5	0.002
34600407	G1/4	34.5	8	15.5	0.004
34600408	G3/8	56	11.5	18.5	0.006
34600409	G1/2	66.5	11	23.3	0.010

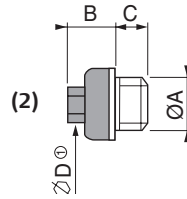

Catalog number	ØA	B	C	ØD	weight
97701875	G 1/8	7	5	7	0.004
97701875	G 1/4	10	6	9	0.010

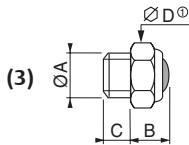

Catalog number	ØA	B	C	ØD	weight
34600484	M5	4.5	3.2	8	0.001
34600418	G 1/8	10	6	13	0.006
34600419	G 1/4	11	8	16	0.010
34600478	G 3/8	11	9	19	0.014
34600479	G 1/2	14	9	24	0.023

① D: Across flats