

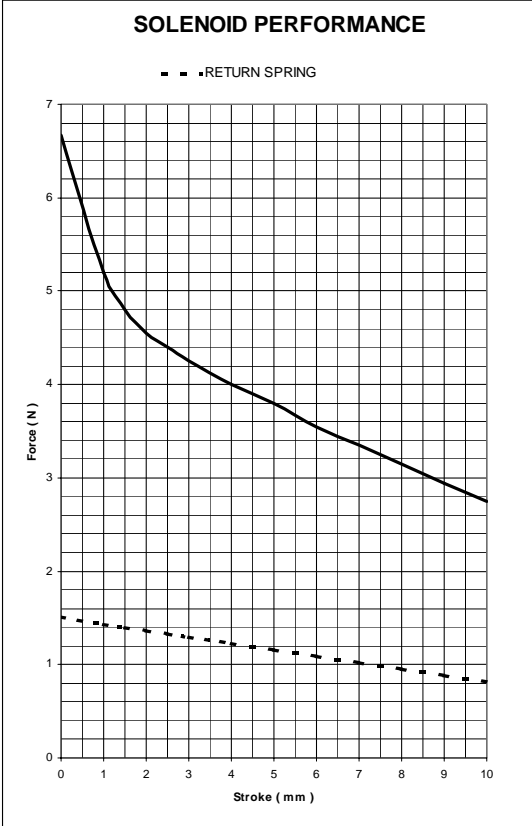

LOCKING SOLENOID FOR LIGHT DUTY APPLICATIONS

C430AN01

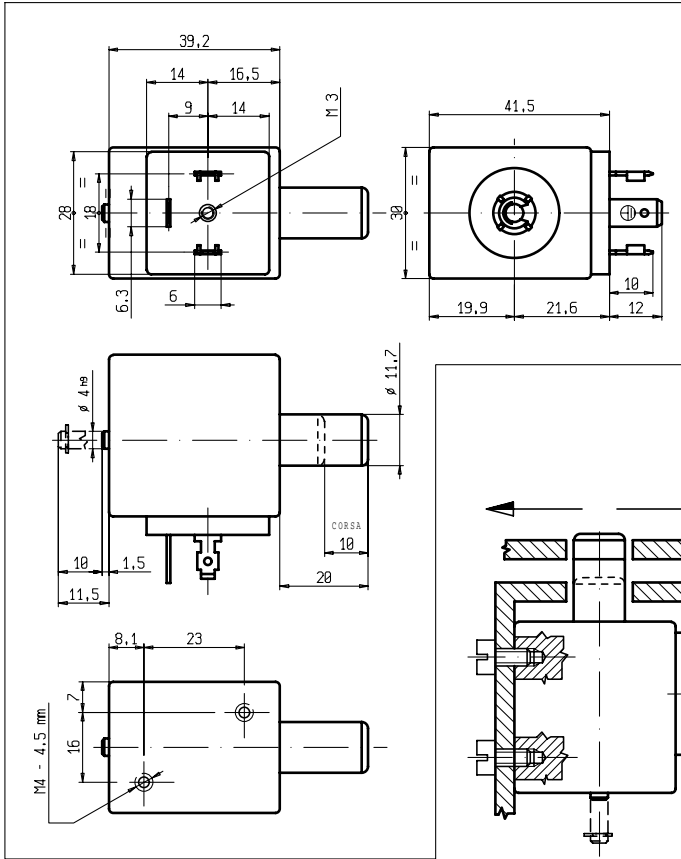

MOUNTING EXAMPLE
(Locking in de-energized conditions)

FEATURES - Series of solenoids with fibreglass reinforced PA (polyamide) encapsulated coil. The core runs in brass guide-tube with return spring. Class F insulation (155°C) with class H wire (180°C). Solenoid vacuum impregnated by polyester resin. Solenoid complying with VDE 0580 directive and 100% inspected.

PROTECTION DEGREE - IP 40 (EN 60529). IP65 (EN 60529) for electrical connections with plug connector with standards.

ELECTRICAL CONNECTIONS - Three spade terminals 6,3 x 0,8 (DIN 46340) for crimped connectors, two line plus one ground terminal. Also suitable for three poles plug connectors (DIN 43650).

STANDARD VOLTAGES - Direct current 12-24 V. Other voltages on request.

VOLTAGE TOLERANCE +10% -10%.

Series and type	Absorption (W)	Stroke (mm)	ED %	Total weight (kg)	Weight of moving core (kg)
C430AN01	15	10	100	0,185	0,032

TEST CONDITIONS - Operating ambient temperature 20°C. Tolerance on the rated voltage -10% with hot solenoid.

THE VALIDITY OF REPORTED DATA IS REFERRED TO THE DATE OF ISSUE. POSSIBLE UPDATING ARE AVAILABLE ON REQUEST

01/09/0110