

L330

► SPARE PARTS

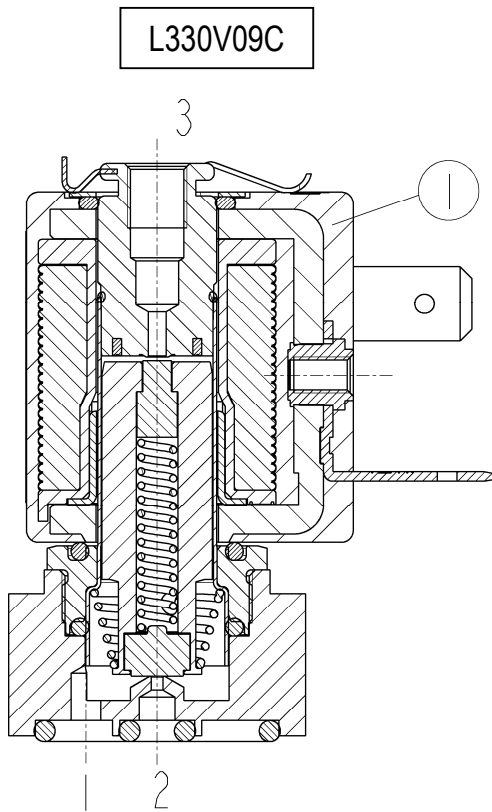

Kit description

Coil

Kit P.N.

ZB12A
Z610A

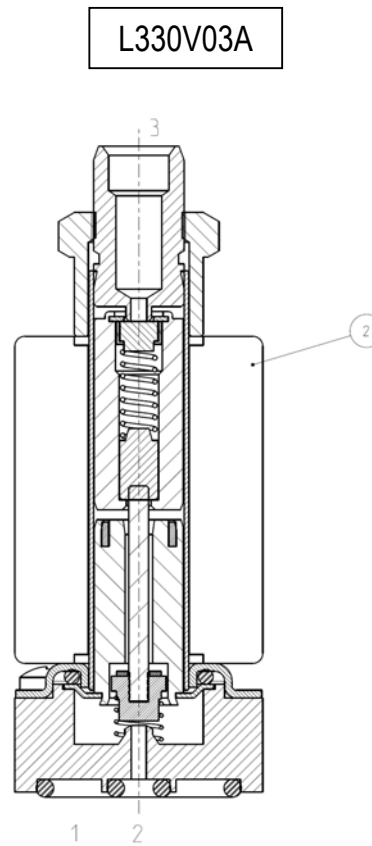

Consisting of:

Coil pos.1
Coil pos.2

► INSTALLATION

- Solenoid valve can be mounted in any position; vertical with coil upwards preferred.

THE VALIDITY OF REPORTED DATA IS REFERRED TO THE DATE OF ISSUE. POSSIBLE UPDATES ARE AVAILABLE ON REQUEST.